

TECHNICAL AND SERVICE BULLETIN

NO: 36

DATE: OCTOBER 1991

TO: ALL KOMPAC DEALERS
SUBJECT: SEAL BURN IN

It has been brought to the attention of Graph Tech that some customers are experiencing seal burn-in problems.

We have attributed these problems to lightweight backing plate springs which were used to compensate for the old style graphite-impregnated seals and also dirt build-up.

Apparently some of these lightweight spring continue to be used and actually are not compatible with the current seals in use. This, along with dirt build-up, has a weakening effect and, therefore, does not exert enough pressure to properly burn in the seals.

If seals not seating properly is a continuing problem, please call Graph Tech Customer Service (1-800-541-5702) for replacement springs, free of charge. Labor, however, will not be credited.

The lightweight springs may be identified by their silver color as opposed to the heavy, bronze colored springs.

Please refer to:

PART #

DESCRIPTION

92238

Compression Spring

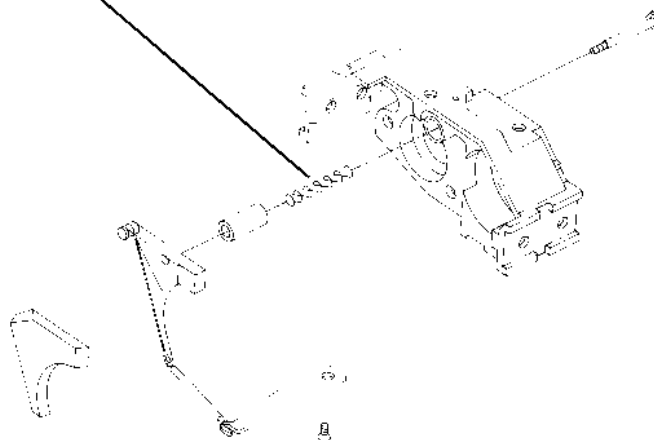

Michael Pek
Technical Kompac Representative

VARN PRODUCTS CO., INC. 175 Route 208, Oakland, New Jersey 07436 • (201) 337-3600

New Jersey • Illinois • Texas • Canada • England • Germany • Australia